

IBM 3164 ASCII Color Display Station Setup Instructions

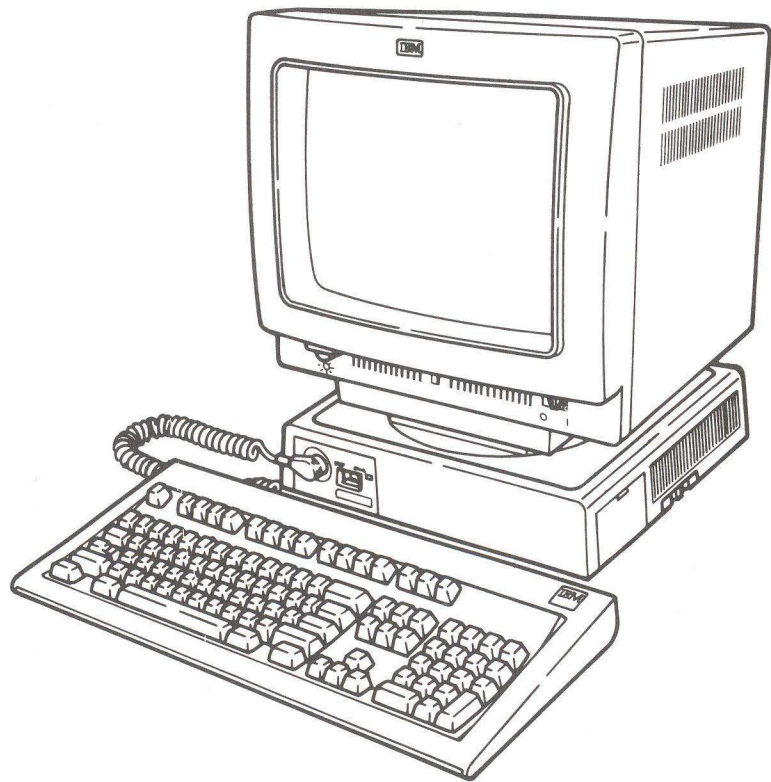

Federal Communications Commission (FCC) Statement

Warning: This equipment generates, uses, and can radiate radio frequency energy and if not installed and used in accordance with the instruction manual, may cause interference to radio communications. It has been tested and found to comply with the limits for a Class A computing device pursuant to Subpart J of Part 15 of FCC Rules, which are designed to provide reasonable protection against such interference when operated in a commercial environment. Operation of this equipment in a residential area is likely to cause interference in which case the user at his own expense will be required to take whatever measures may be required to correct the interference.

The above FCC statement applies only to those machines used in the U.S.

Second Edition (February 1986)

This major revision obsoletes GA18-2319-0.

Reference in this publication to IBM products, programs, or services does not imply that IBM intends to make these available in all countries in which IBM operates. Any reference to an IBM program product in this publication is not intended to state or imply that only IBM's program product may be used. Any functionally equivalent program may be used instead.

No tools are necessary for setting up your display station.

1 Check parts.

Check each box () as you unpack and identify each item. If any required items are missing, call your IBM marketing representative or place of purchase.

Video Element

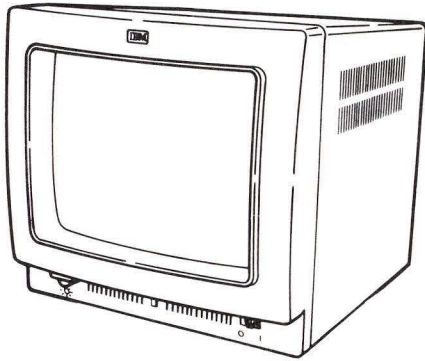

Video Stand

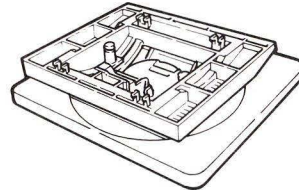

Video Cable

Power Cord

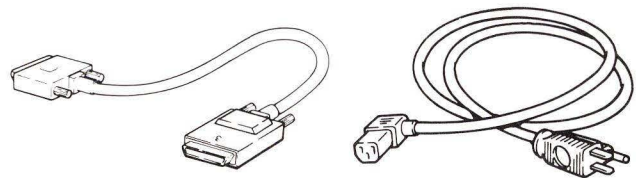

Logic Element

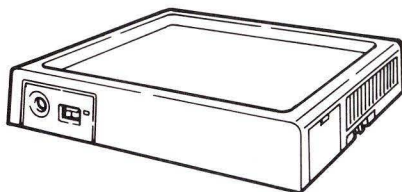

Operator Reference and
Problem Solving Guide

Description Manual

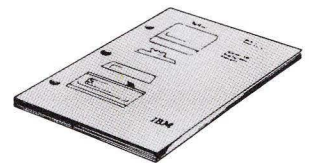

Keyboard

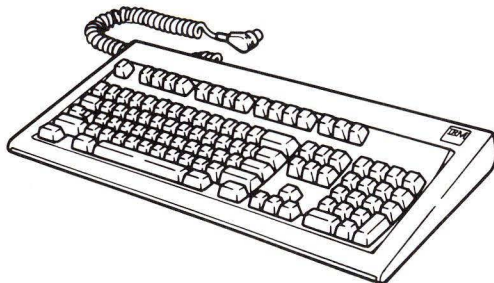

Keyboard Overlay

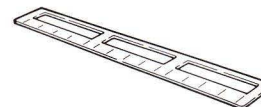

Note: Save all packing material for possible later use.

2 Attach tags.

a Tear off the upper half of the label from the back of the logic element.

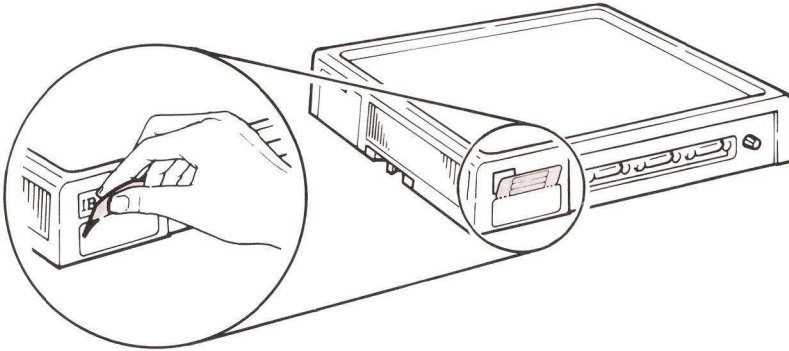

b Attach tags to the back of the video element, the bottom of the keyboard, and the front of the logic element.

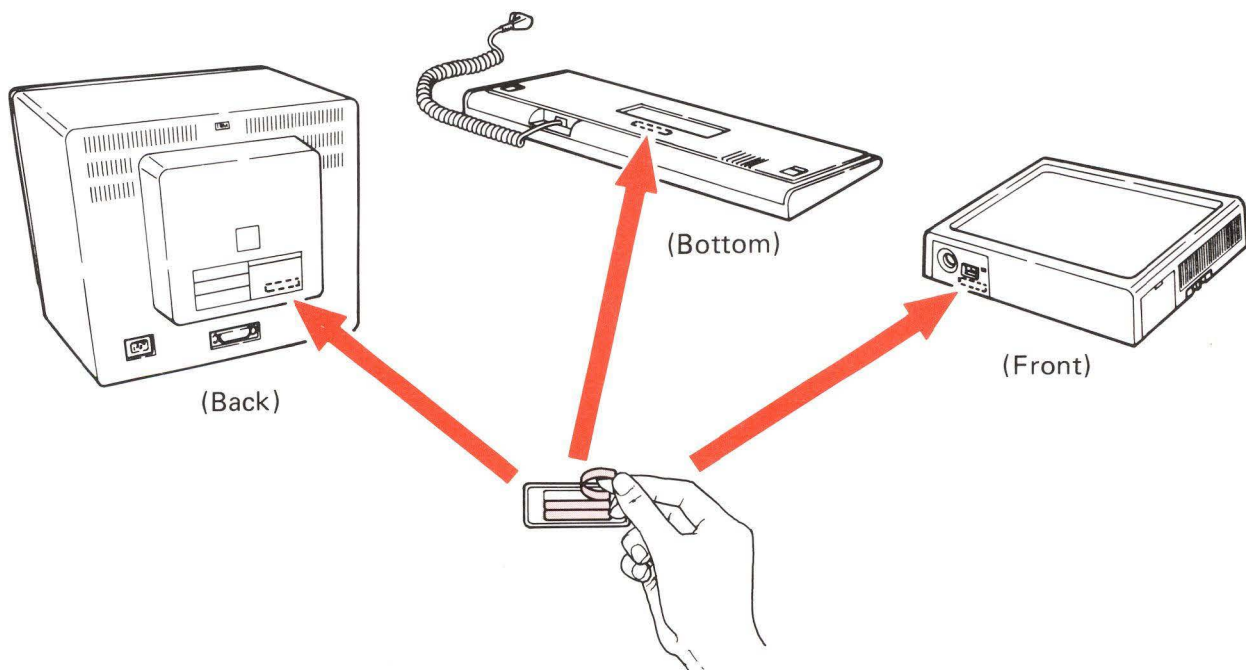

IMPORTANT

If you do not attach the tags, there may be a substantial delay in the return of the repaired element due to the time required by IBM to determine the unit's maintenance agreement status.

3 Attach stand to video element.

a Turn the video element so that the screen faces up.

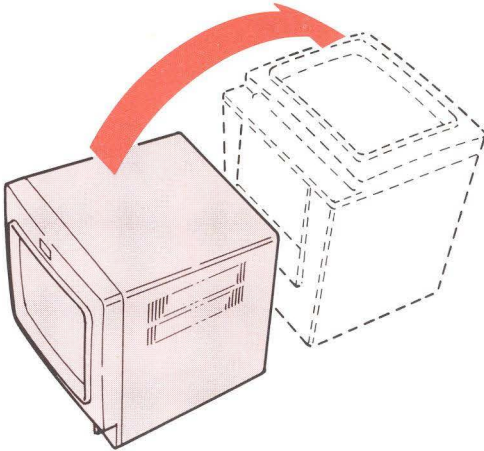

b Insert the hooks (make sure they are pointing up—see detail A) into the slots and lift the stand to lock it to the video element.

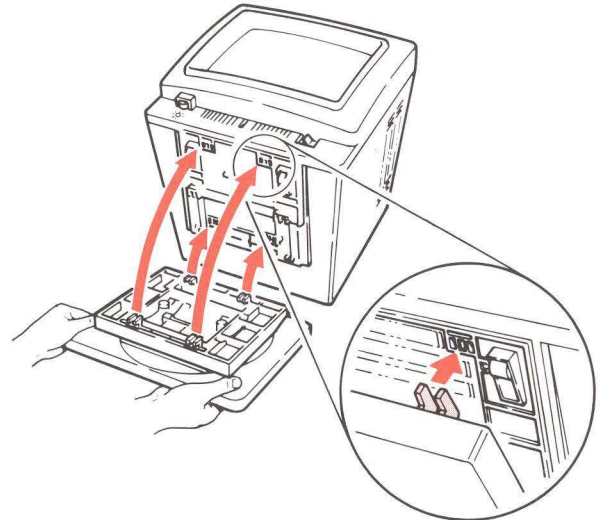

Detail A

c Move the stand up and down to make sure it is locked to the video element.

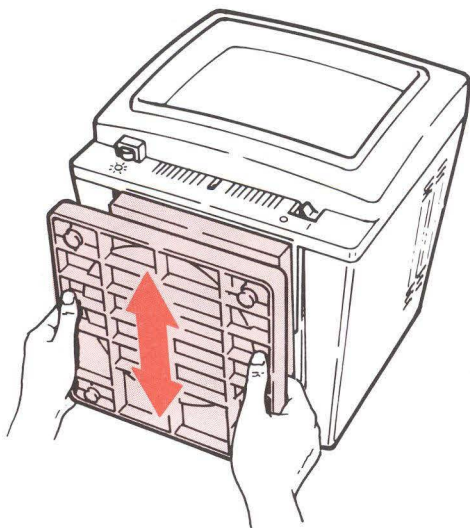

d Return the video assembly to its normal position.

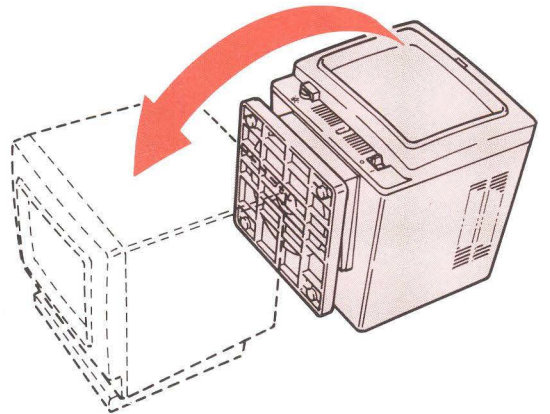

4 Connect cables.

a With help from another person, hold the video assembly as shown; lift it onto the logic element. (Be careful not to pinch your fingers.)

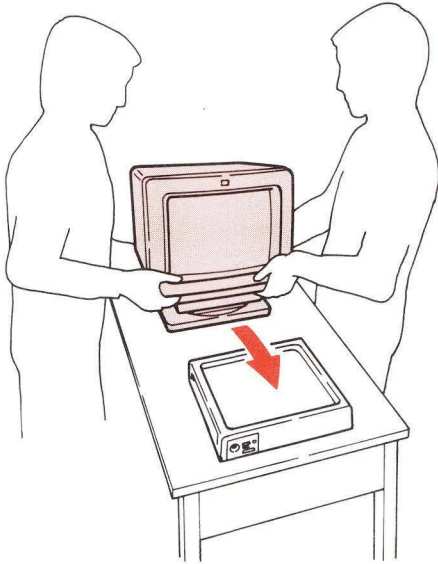

b Insert the end of the video cable **3** firmly into the logic element, and tighten the screws.

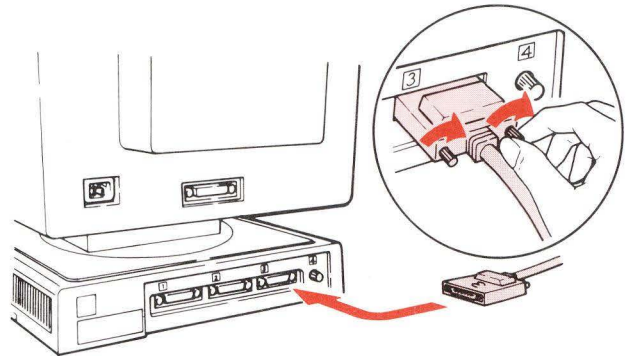

c Insert the other end of the video cable firmly into the video element, and tighten the screws.

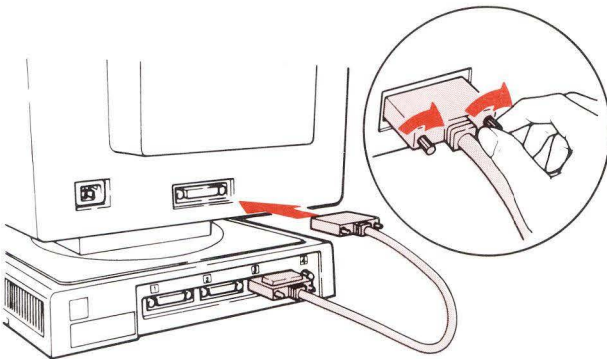

d Insert the keyboard cable firmly into the logic element.

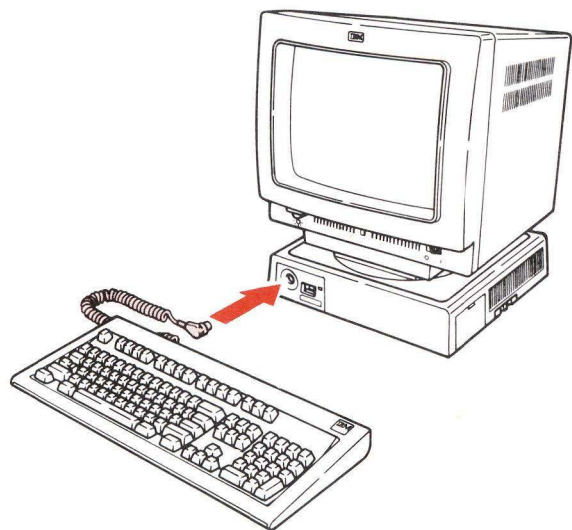

5 Apply power to display station.

a Make sure that the power switch is set to O (Off).

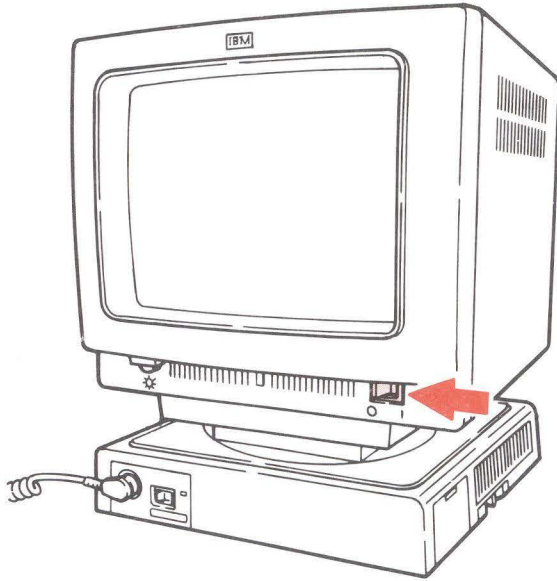

b Insert the *female* end of the power cord into the video element.

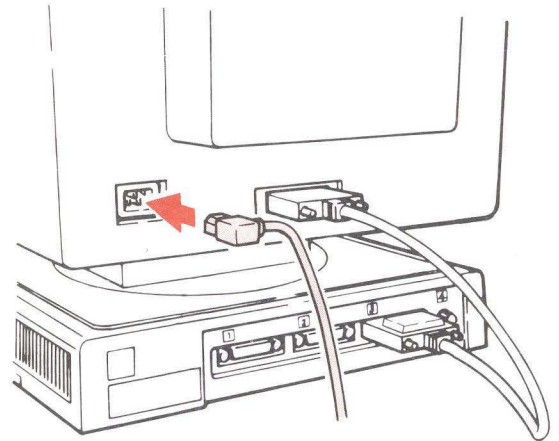

c Insert the other end of the power cord into a power outlet.

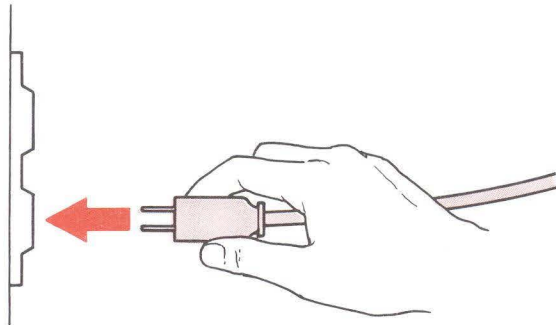

d Set the power switch to I (On).
The power-on light should come on.

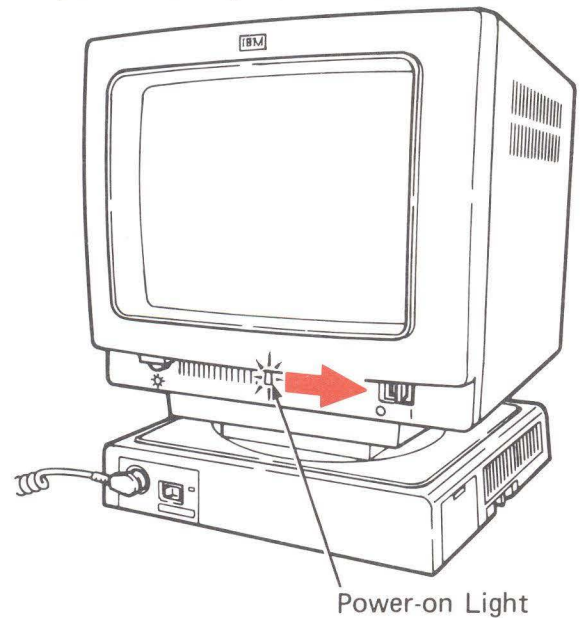

If any step in 5, 6, 7, or 8 produces an unexpected result, see *IBM 3164 ASCII Color Display Station Operator Reference and Problem Solving Guide*, GA18-2318.

6 Adjust screen brightness.

a Set the Test/Normal switch to Test. The logic light should blink and a test pattern will appear.

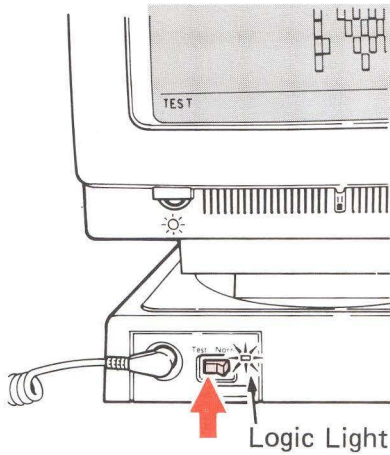

b Turn the knob (☀️) to adjust the brightness.

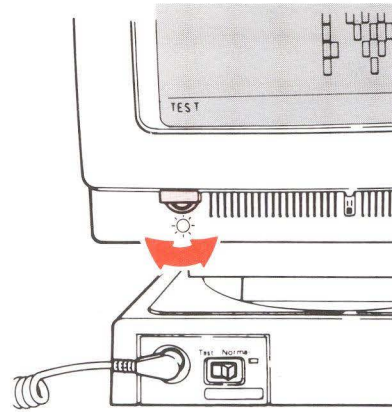

7 Check test pattern.

Verify that your screen looks similar to this. Fields should appear in the colors indicated.

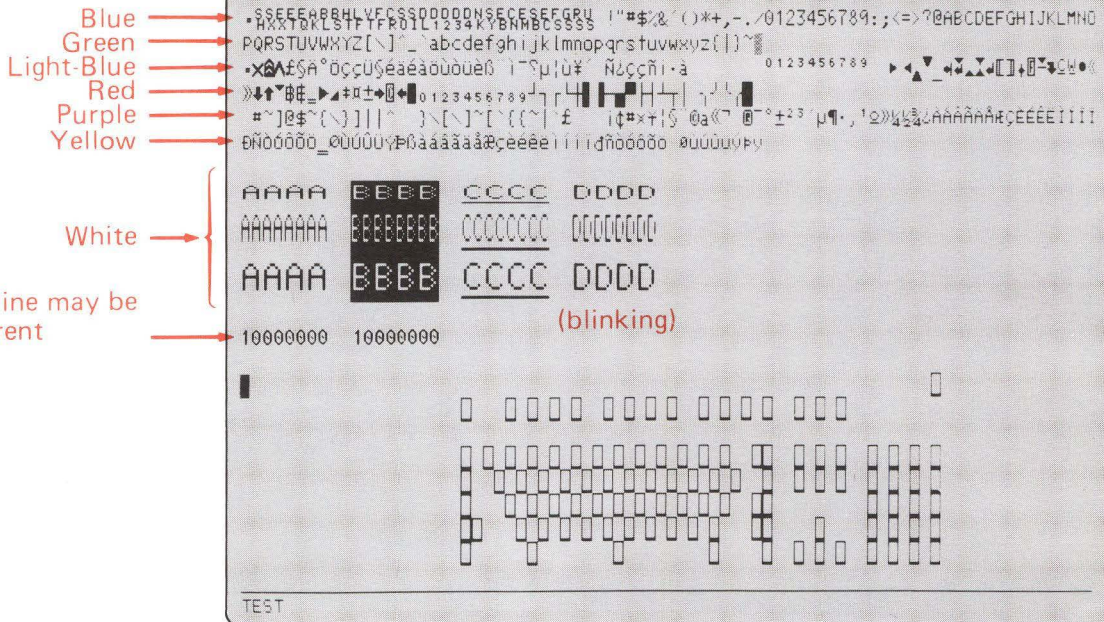

8 Adjust alarm volume.

a Locate the alarm-volume control **4** on the back of the logic element.

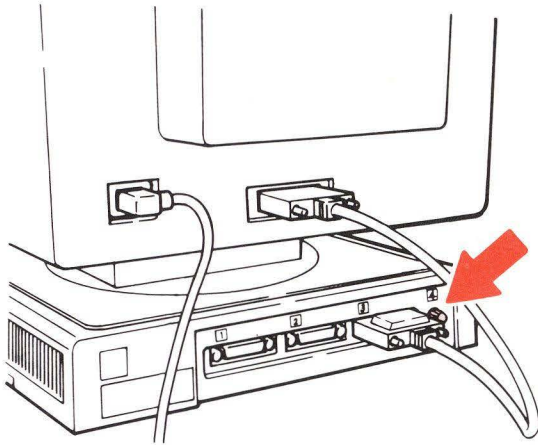

b Set the Test/Normal switch to Normal, then back to Test. *The audible alarm should sound.*

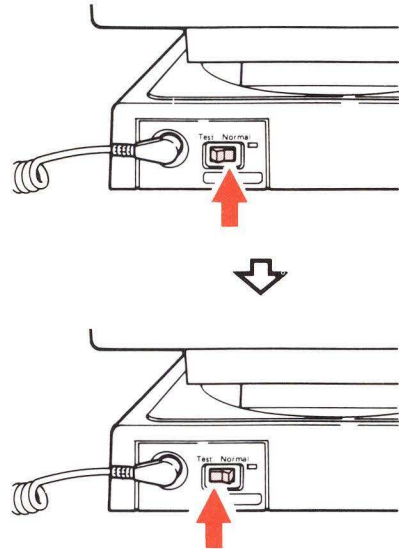

c Adjust the volume control.

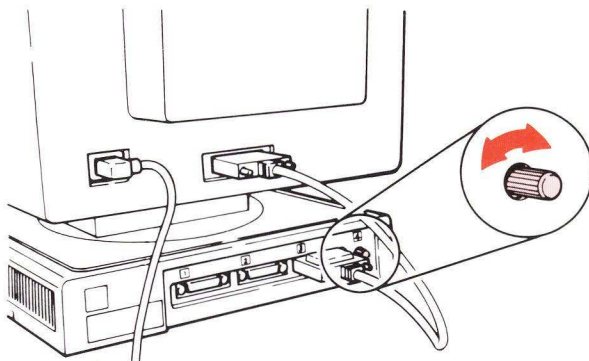

d Repeat steps **b** and **c** until the alarm is set at a comfortable level.

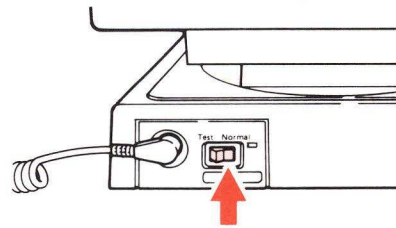

Set the Test/Normal switch to Normal.

9 Set communication values.

a Get the setup sheet. (Your supervisor should have filled it out according to *IBM 3164 ASCII Color Display Station Description, GA18-2317.*)

Make sure that the Test/Normal switch is set to Normal.

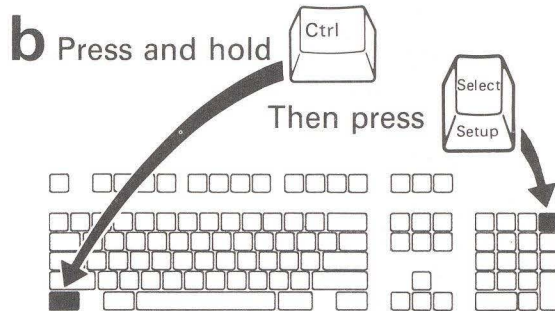

A setup menu should appear as shown below.

Note: If a select menu (a single line of characters at the bottom of the screen) appears instead, press Select and retry step b.

c Compare your setup sheet and the screen to find which fields you need to change.

If all fields match, go to step **f** on the next page. If any field does not match, you need to change the values on the screen; go to step **d** on the next page. (To change values, press the space bar.)

Compare

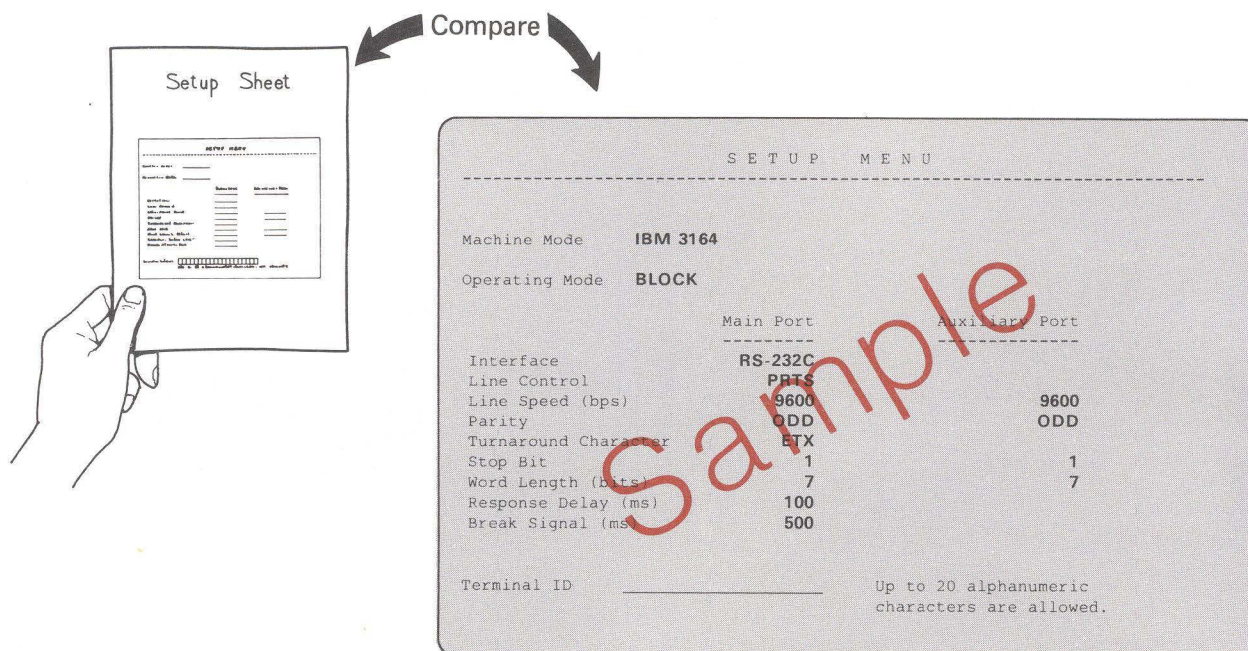

Setup Sheet

RETRY HARD

Machine Mode	Operating Mode	Main Port	Auxiliary Port
IBM 3164	BLOCK	RS-232C	
		Line Control	PRTS
		Line Speed (bps)	9600
		Parity	ODD
		Turnaround Character	ETX
		Stop Bit	1
		Word Length (bits)	7
		Response Delay (ms)	100
		Break Signal (ms)	500

SETUP MENU

Machine Mode **IBM 3164**

Operating Mode **BLOCK**

	Main Port	Auxiliary Port
Interface	RS-232C	
Line Control	PRTS	
Line Speed (bps)	9600	9600
Parity	ODD	ODD
Turnaround Character	ETX	
Stop Bit	1	1
Word Length (bits)	7	7
Response Delay (ms)	100	
Break Signal (ms)	500	

Terminal ID _____ Up to 20 alphanumeric characters are allowed.

(Your screen with the IBM-supplied settings)

If you select an IBM 3101 for Machine Mode, your screen will change.

9 (Continued)

d

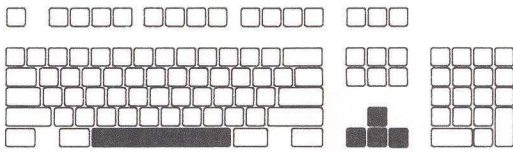

(1) Use  ,  ,  or 

to select any field whose value you want to change.

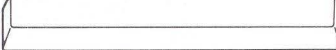
(2) Then press 
(Space Bar)

until the desired value appears.

(3) Repeat substeps (1) and (2) until all values match the setup sheet.

e Select the Terminal ID field and type in your terminal ID (if specified).

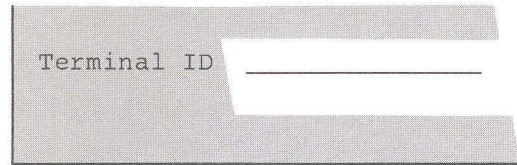

f Record all values shown on the screen into the setup memo in Appendix A of *IBM 3164 ASCII Color Display Station Operator Reference and Problem Solving Guide*, GA18-2318.

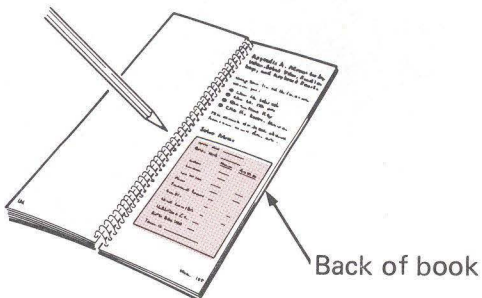

g Press



IMPORTANT

Contact your supervisor to define the SELECT values. If the SELECT values are not defined for your system, the display station may not operate correctly. Information for defining the SELECT values is described in *IBM 3164 ASCII Color Display Station Description*, GA18-2317.

10 Position video element for viewing comfort.

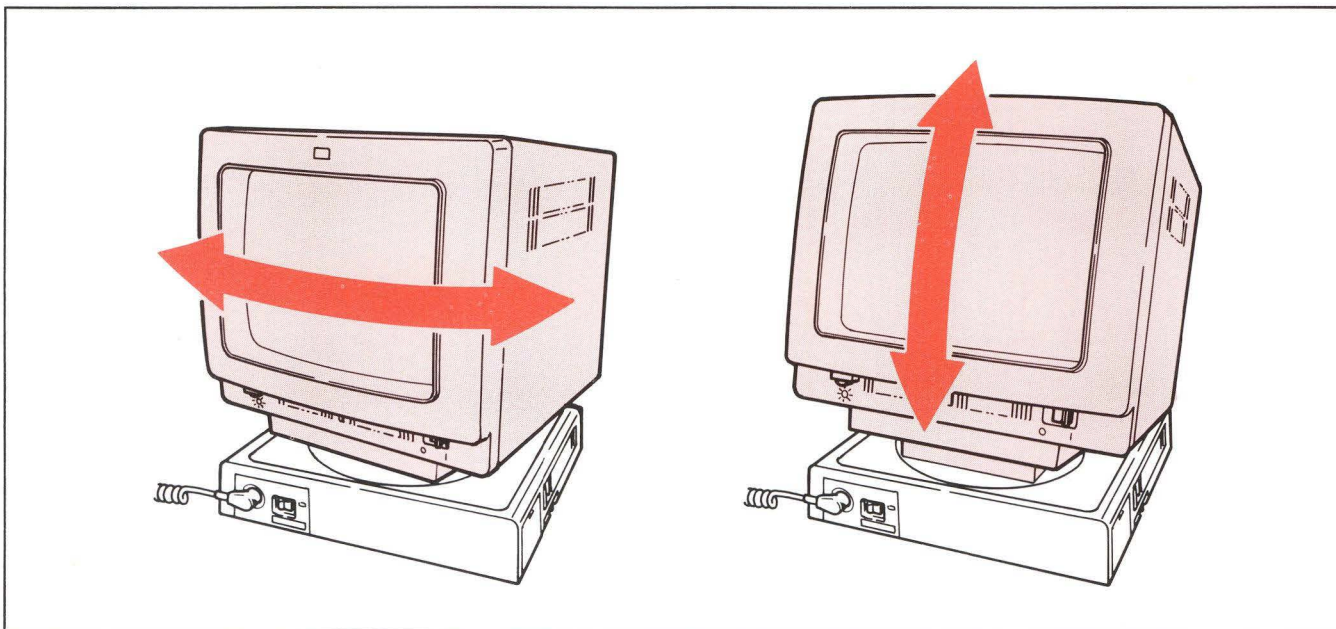

11 Set keyboard angle for your comfort.

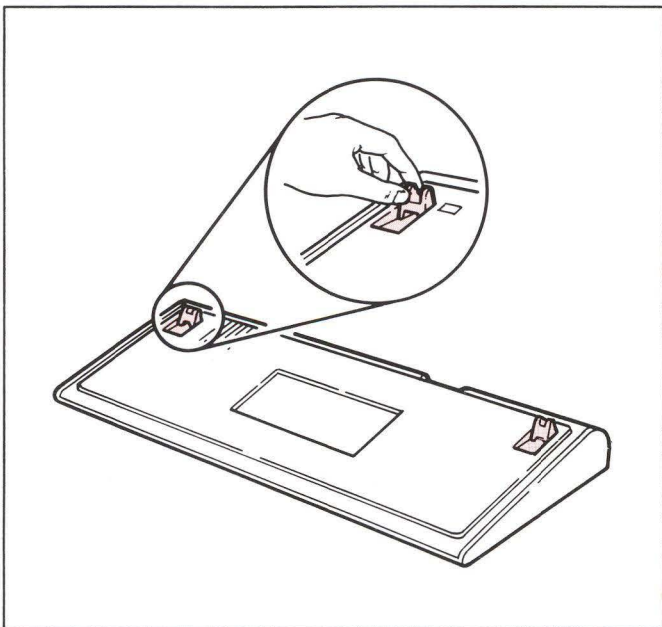

12 Place keyboard overlay over keys.

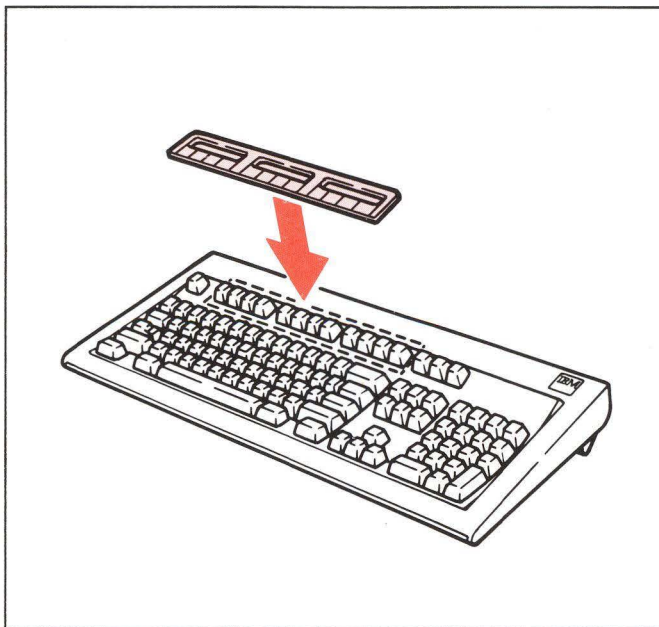

13 Place *operator reference and problem solving guide* into drawer as shown.

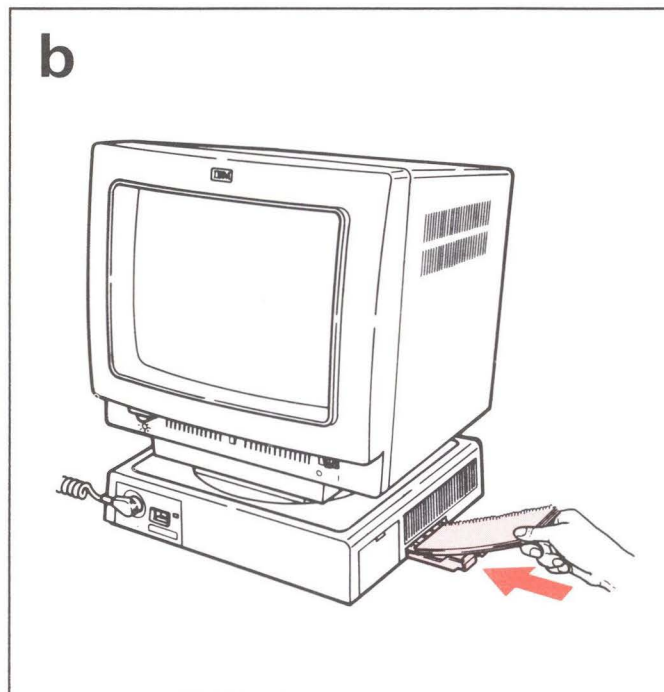
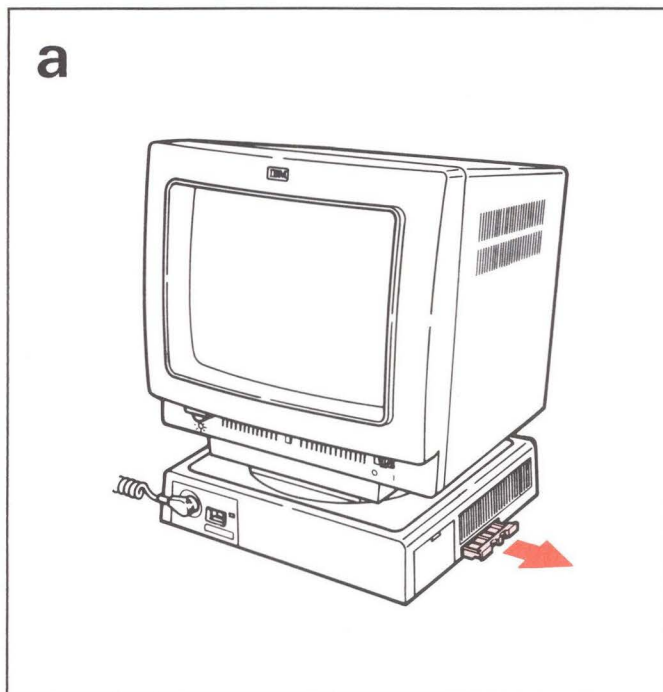

Setup is now complete.

Go to step 14 to connect your display station to the host system.

14 Connect communication and optional device cables.

a Set the power switch to O (Off).

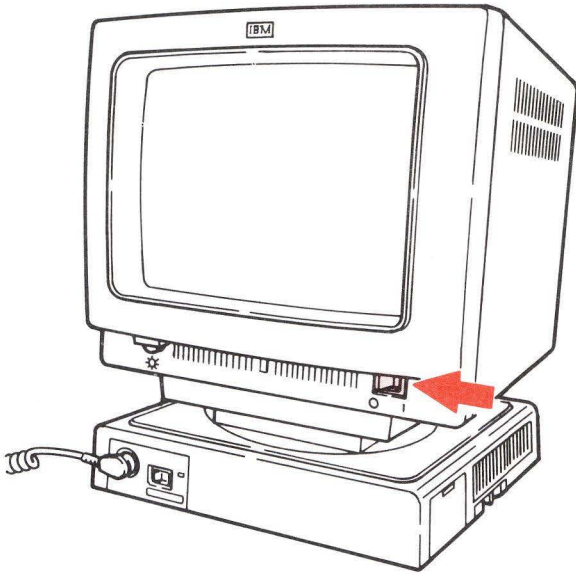

b **DANGER**
Do not perform this step during an electrical storm. Communication cables can conduct lethal charges of lightning.
Insert the communication cable firmly into the logic element **2**, and tighten the screws.

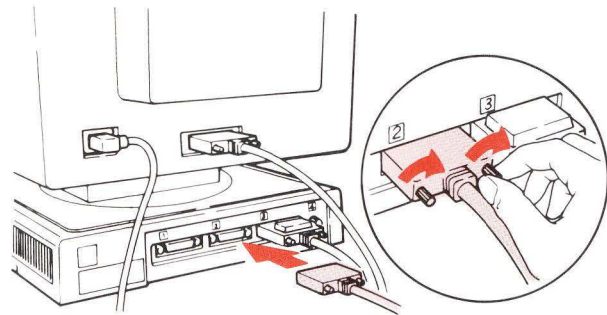

c To connect a printer or any other optional device, insert its cable into the logic element **1** and tighten the screws.

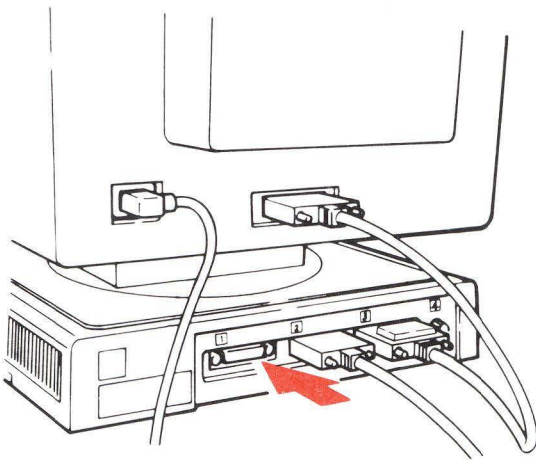

Refer to *IBM 3164 ASCII Color Display Station Description, GA18-2317* for personalizing your display station (for example, changing select values or keyboard functions).

Retain this manual for possible later use.

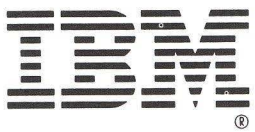

GA18-2319-01

