

IBM Datacap Taskmaster Capture



Capture For The Enterprise

Presenters: Reggie Twigg, David Jenness, Tom Simalchik

Date: January 26, 2011

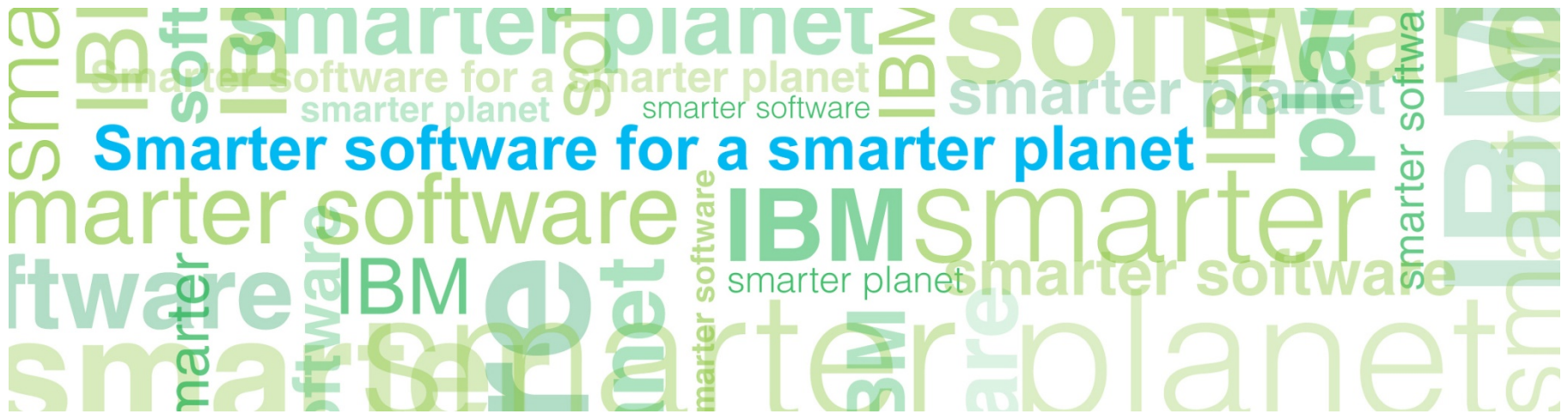

Agenda

- The Strategic Nature Of Capture
- The Power of Enterprise Capture
- Datacap Taskmaster Capture
- Industries and Applications
- Determining the ROI
- Software Demonstration
- Q & A



Strategic Nature of Capture

- Capture applications are the gateway to enterprise content strategies
- Driven by several key value components:
 - FTE reduction / repurposing
 - Data entry error reduction
 - Document transportation costs
 - Document retention costs
- Growing document production (paper and electronic) and government regulation mean that Capture/ECM projects remain viable and justifiable even in uncertain economic times

Why do Customers Invest in Document Capture?

■ High Volume Document Capture and Imaging

- Driving Process Optimization
- Organizations with large quantities of paper-based transactions need to digitize the transactions to support applications such as: Accounts Payable Invoices, Loan Origination and Servicing, Account Opening, Insurance Claims, Government Tax, Socials Benefits, & Licenses.

■ Advanced Case Management

- Make effective decisions and optimize case outcomes
- In-process-capture integrates unstructured content in mission critical business processes and enabling analytics to uncover key business insights for better decision making

■ Information Lifecycle Governance

- Trusted content reduces legal risk and governance costs
- Datacap Captures and extracts meaning from unstructured information at the source to protect the chain of custody of critical business documents.

■ Green Initiatives

- Paperless technology reduces costs and improves efficiencies by reducing physical storage, transportation, and paper consumption.

■ Platform Standardization

- Across the enterprise, customers seek a consistent set of document capture technologies integrated with their ECM stack across all lines of business.

■ Rapid Return on Investment

- Automating capture processes takes on ECM's highest ongoing cost - labor associated with processing and transporting paper documents - easily-identifiable justification for the customer's investment.



The benefits of document imaging & capture

- Better **customer/vendor service** and communications
- **Reduced time and resources** required to manage paper and related business processes
- **Improved cash flow**, reduced transaction and paper costs while growing the business
- **Improved collaboration** as documents can be immediately accessed and shared around the world
- **Elimination of lost files**
- Secure and reliable **backup and disaster recovery**
- And overall **Return On Investment**



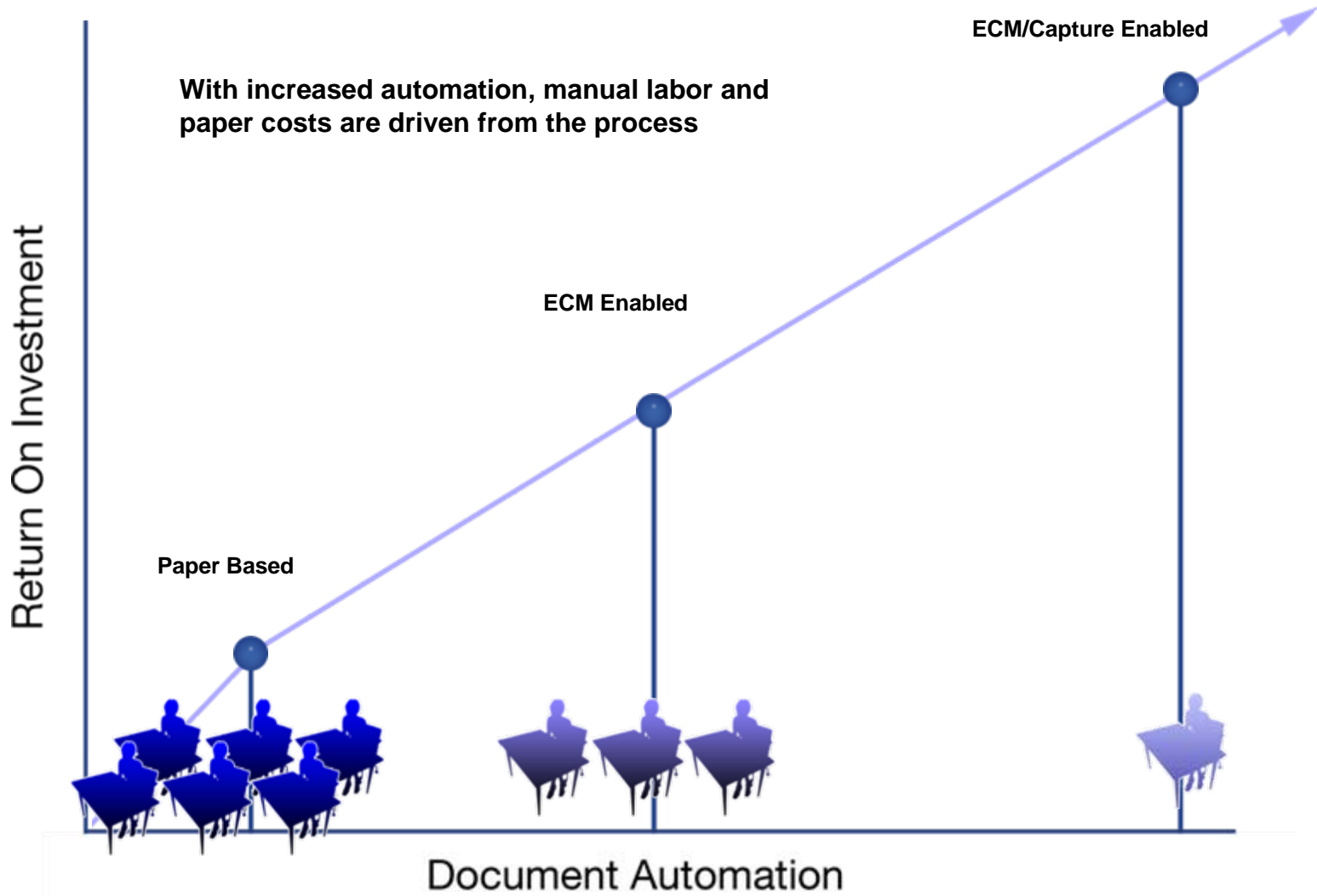

What Do You Mean By Capture?

Basic Capture?



Departmental Capture?



Enterprise Capture?



Capture Capabilities Scale

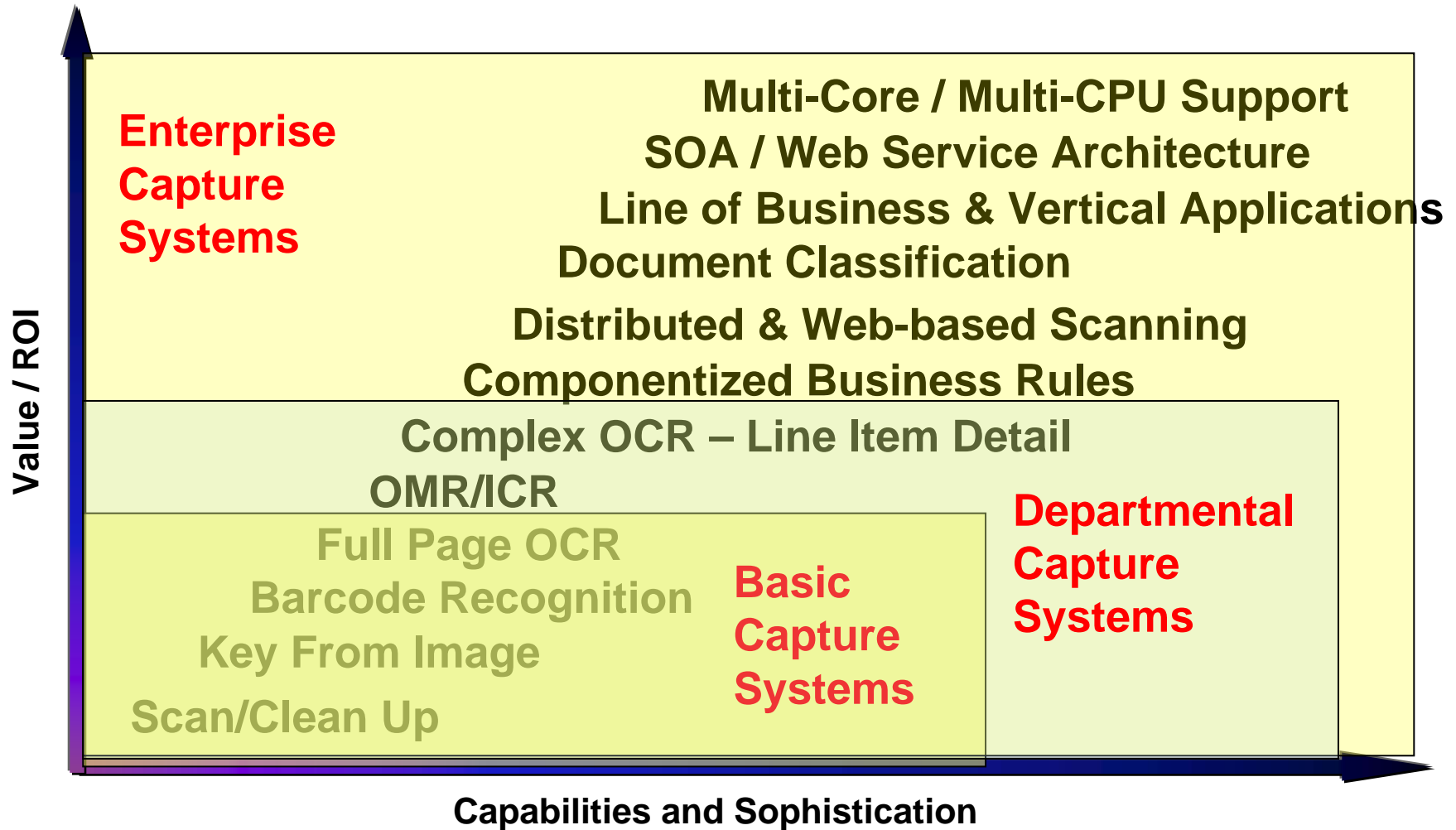

Components of Enterprise Capture

Mailroom



Department



Branch



Document Types:

- Records
- Applications
- Forms
- Correspondence
- Policies
- Inventories
- R&D documents
- Tax documents
- Regulatory
- Surveys
- Subscriptions
- Invoices
- Claims
- Sales Orders
- Purchase orders
- Medical
- Records/EOBs
- Sales and Service
- Applications
- Human Resources
- Inventories
- Loan documents
- Proofs of delivery

Capture Capabilities Required:

- High volume Scanning
- Automated Indexing
- Document ID and Classification
- Handprint capture (ICR)
- Machine print capture (OCR)
- Checkbox (OMR)
- Barcode
- Email input
- Fax input
- ERP integration
- Adjudication integration
- Thin client implementation
- Robust reporting

Field



Components of Enterprise Capture

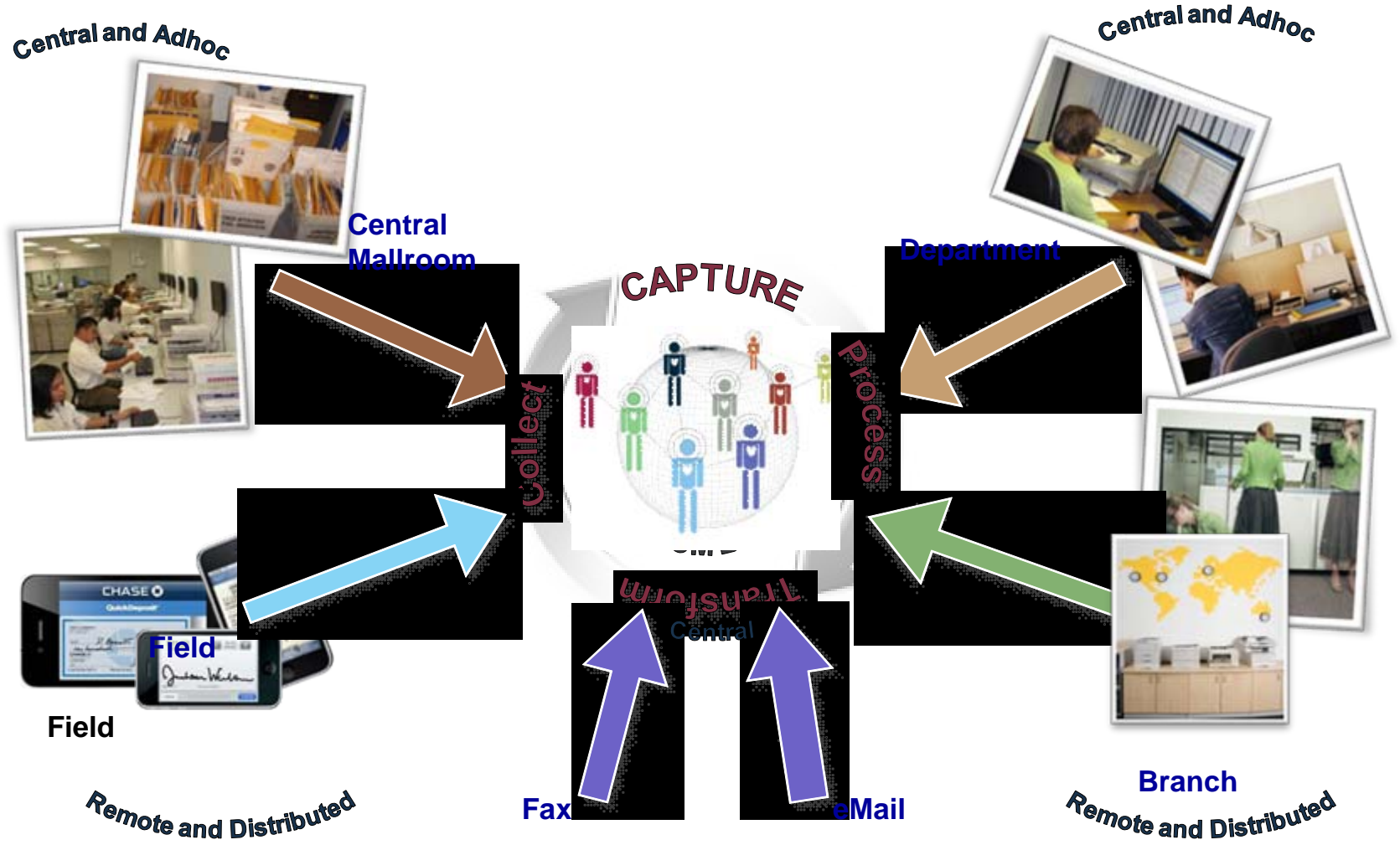



Taskmaster

The Enterprise Capture Platform

Problem: Traditional Capture Process is Inflexible



Taskmaster Architecture: Robust, Flexible, Scalable

- Accounts Payable
- Healthcare
- Insurance
- Government
- Financial Services
- Transportation
- Manufacturing

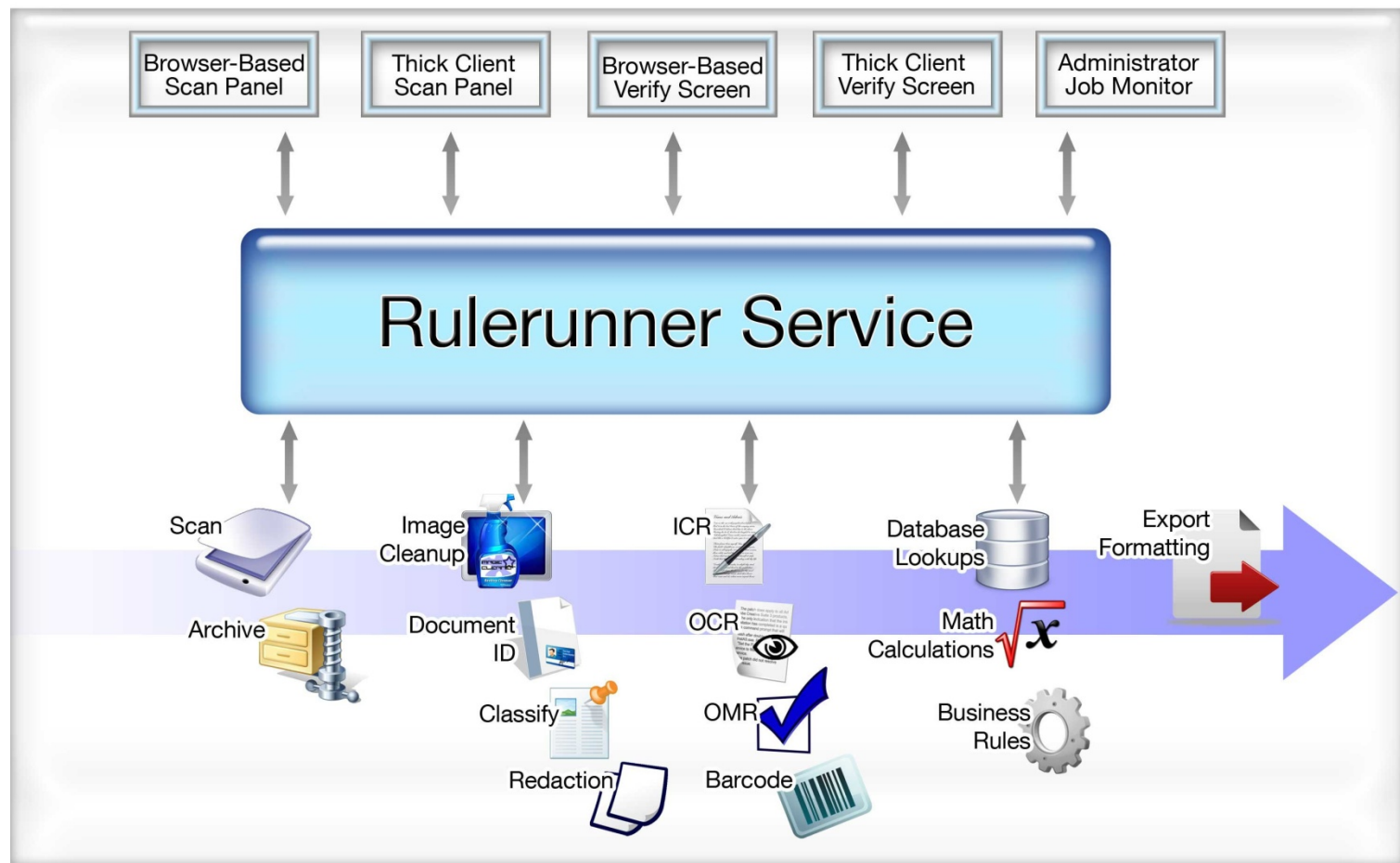

Key Industries / Applications

Government

- Tax Returns
- Property Taxes
- Motor Vehicles / Public Safety

Transportation / Logistics

- Commercial Invoices
- Customs Documents
- Brokers Orders

Healthcare

- EOBs
- Medical Records / EMR / EHR
- Healthcare Claims

Corporate AP (Invoices)

- Header Level Recognition
- Line Item Detail Extraction
- ECM / ERP Integration

Distributed Scanning

- Large # of satellite office
- Remote Scan, Process Centrally
- Improved Provisioning

Financial Services & Insurance

- Loan Documents
- Account Service Requests
- Applications & Enrollment

IBM Datacap Taskmaster Capture

- Production Document Capture
 - Central (corporate or mailroom-type) high volume scanning and indexing
 - Departmental Applications with key data extraction
 - Branch (full-function, web-based distributed deployments)
- Procedural Rules deliver the flexibility required by Enterprise Capture. Use rules to govern every step in the capture process, including:
 - Input images from multiple sources including scanners, MFDs, folders, Fax, Email
 - Process images
 - Image enhancement – deskew, remove lines, noise, rotate, etc.
 - Document classification (including Fingerprints to identify), page separation
 - Extracts data using OCR, ICR, OMR, barcode 1D and 2D technologies
 - Validates data including lookups (and retrievals)
 - Intuitive User Interface for data entry, edit and verification
 - Learns from human operator handling of exceptions
 - Thin and thick clients have same functionality
 - Export to select back-end ECM repositories and ERP/databases
- Administration
 - Web-based monitoring and administration
 - Extensive Reporting

Datacap Taskmaster Delivers a Rapid ROI

- Reduce cost of transporting paper to a central location
 - Scan documents in remote locations – branches, stores, offices, etc.
 - Savings can be more than \$1M annually
 - Key capability - Distributed Capture

- Reduce data entry labor costs
 - Extract data from documents without manual keying
 - Potential to reduce data entry staff up to 90%
 - Large organizations can have hundreds of employees performing data entry
 - Key capabilities – Rules, Advanced Data Extraction

- Reduce cost of document capture
 - Reduce paper sorting and document preparation
 - Potential to reduce capture staff up to 50%
 - Key capabilities – Rules, Advanced Data Extraction

- Standardize
 - Single vendor ECM solution
 - Replace obsolete or costly legacy capture systems
 - Reduce license fees, support and maintenance costs
 - Eliminate volume-based pricing



What Sets IBM Apart?

- Rulerunner Service is IBM Datacap's Rules Execution Engine - none of our competitors offer this capability
 - Implements in weeks not months
 - Quickly adapts to change
 - Call Rulerunner Service via SOA service from applications for in-process capture
- Attractive, User-based Pricing
 - Competitors charge per page which is excessively costly, inflexible and unpopular
- Single product for both basic and advanced capture
 - Scalable from a single client to thousands
 - Includes advanced data extraction and many capabilities that are expensive add-on modules in our competitor's products
 - Local and distributed
 - Thick and thin clients on a single platform

Benefits of IBM's Single Vendor Capture and ECM Portfolio

- Lower Total Cost of Ownership with consistent licensing and maintenance
 - Capture typically less than 1:1 (services:software)
 - Fewer vendor contracts to administer
 - Reduced training and administration
- Document Capture is the “onramp” to strategic Enterprise Content Management solutions
 - Production Imaging
 - Advanced Case Management
 - Information Lifecycle Governance
 - In process capture – call capture as service from any point in ECM process
- Organizations with large quantities of document-based transactions can use capture to streamline such applications as: Accounts Payable Invoices, Loan Origination and Servicing, Account Opening, Insurance Claims, Government Tax, Social Benefits, & Licenses built on IBM ECM platforms

Single Vendor = \$\$\$ Savings

IBM Production Imaging Edition

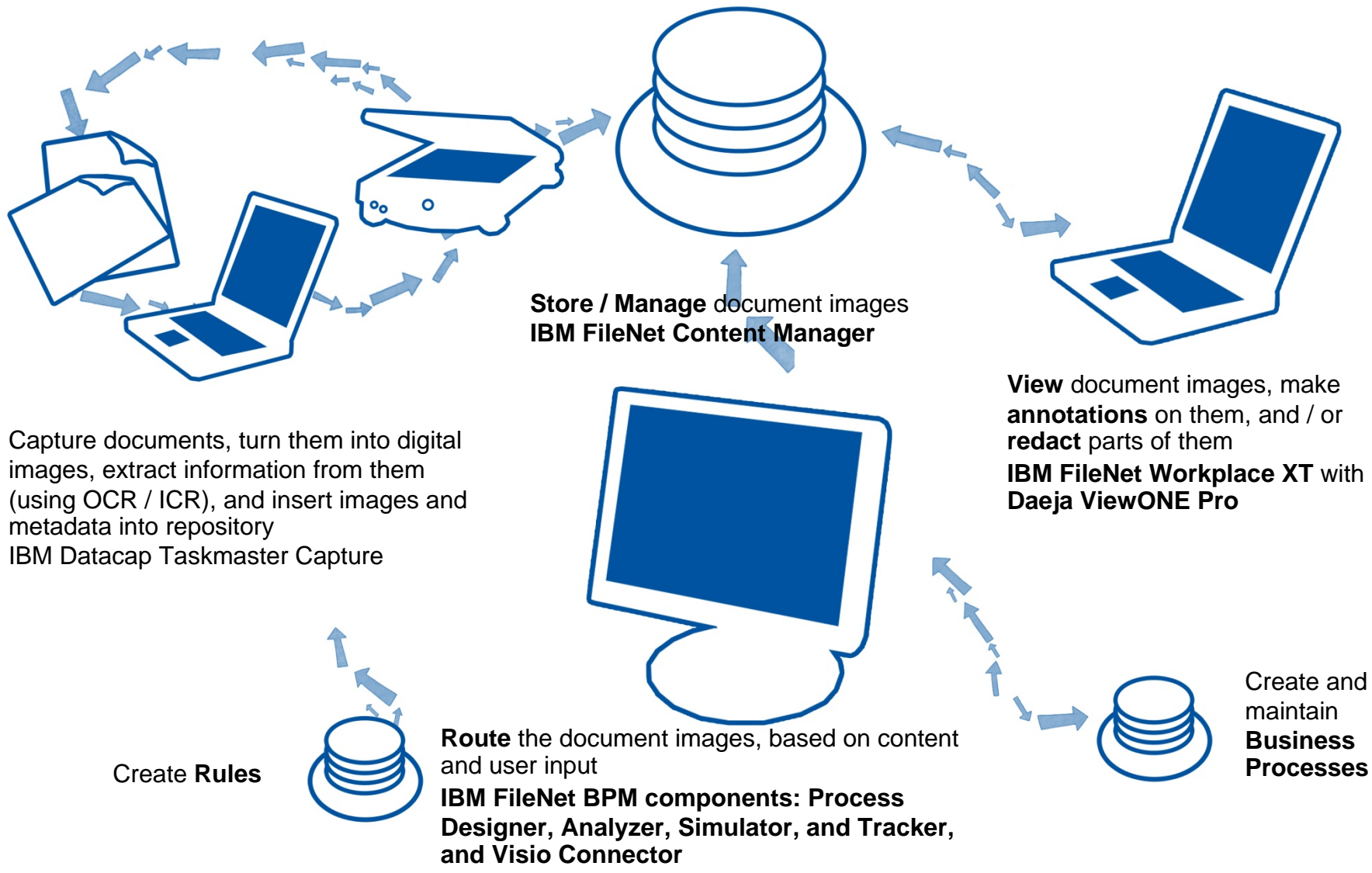

Developing the ROI: What is document input costing you today?

- Paper based: No scanning
 - Forms arrive as paper
 - Forms are processed as paper
 - Forms are saved as paper
 - **Expensive personnel costs, filing retrieval, storage**
 - **Hi potential for lost or misfiled documents**
 - **Customer service suffers**
- Scanning for archival purposes only
 - Scanning paper forms
 - Images saved in document management system
 - **Less expensive than paper-based**
 - **Potential for data entry errors**
 - **Customer service improves**



Capture, ECM and Optimized Business Processes

- Automated Capture and Business Processes
 - Documents are scanned
 - Data is captured
 - Images & data routed for processing using BPM
 - Images saved in an ECM repository
- Much less expensive than paper based over time
 - Reduced personnel cost
 - Less Filing/Retrieval management
 - Real estate/Long term storage
 - AP Capture helps enable discounts
- Low potential for data entry errors
- Multi user system
- Customer service really improves!



... and you can dispose of the paper!

Demonstration Taskmaster Distributed Capture

Tom Simalchik
Datacap Product Marketing Manager

- Taskmaster APT for invoice capture
 - Distributed scanning
 - Centralized document processing
 - Distributed and centralized document verification
 - Distributed and centralized administration
 - Extensive data validations, database lookups and retrievals

Q & A