

Help protect your most valuable data and application assets continuously.



Highlights

- Help protect laptop and desktop data 24 hours a day
- Leverage point-in-time-based and arbitrary-version recovery to roll back to precisely the data you require
- Set options for high- and low-priority files and predefined retention times
- Help control costs with easy implementation and integrated service and administration

Back up your most valuable data: current work files

For most knowledge workers today, the eight-hour workday is a thing of the past. Clicking away at laptops and desktops, these individuals work at home, in the office and on the road — at all hours of the day and night. According to some industry experts, the work they generate adds up to 60 to 70 percent of all corporate data. And it's all increasingly vulnerable to data loss and corruption.

It's no surprise, then, that the protection of laptop and desktop data has become a top priority in many businesses — especially law firms, medical practices and consulting firms, where lost data can significantly impact productivity, customer satisfaction and, ultimately, revenue. Losing key business information

not only hampers productivity, but also creates application outages, project delays and diverted resources.

For companies working in an Internet service provider (ISP) environment, the ability to protect, manage and recover data is especially important and challenging, because it often involves encrypted data flowing across the Internet from hundreds of thousands of users. Small and medium-sized businesses that have users working in remote offices also struggle to back up, manage and recover important laptop and desktop data.

What's more, it's no longer enough to back up this data periodically. The most valuable files are usually the ones that users have worked on most recently. That means that companies backing

up data only once every 24 hours risk losing eight or more hours of their employees' most recent — and therefore most valuable — output. Instead, businesses need a continuous, real-time backup and recovery solution that enables users to roll back to various points in time.

Once critical laptop and desktop data is captured, companies need an efficient and cost-effective way to manage it. They need to determine its value to the company and apply appropriate corporate policies for retention and storage. By doing so, a business helps prepare itself for any regulatory scrutiny it may face in the future — or for legal requirements to use formal data protection.

Get a simple, powerful backup and recovery solution

The answer to these very real concerns is a simple, yet powerful solution from IBM that involves just three tightly integrated components:

- *Continuous data protection* — IBM Tivoli® Continuous Data Protection for Files provides real-time, continuous data protection designed specifically for laptops and desktops. Instead of waiting for a scheduled interval — typically 24 hours — it backs up your users' most important files the moment they are saved, in real time.

Tivoli Continuous Data Protection for Files

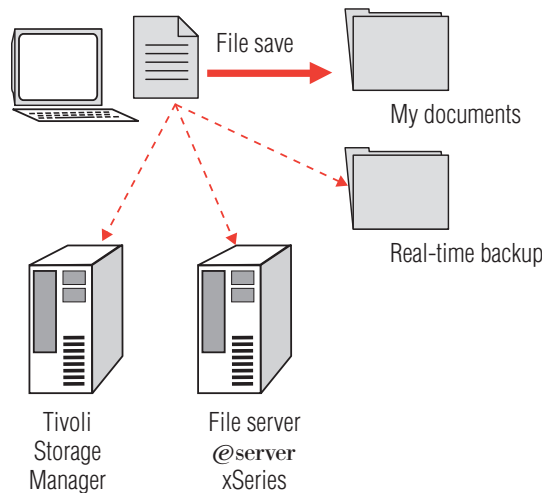

- Airbag-like protection
- Continuously protects important files
- Transparently runs in the background
- Multiple copies
 - Local cache – highest performance, least impact and greatest availability
 - Off-machine – in case of loss, theft or disk failure
- Network adaptive
- Eliminates backup windows
- Point-in-time recovery
- Easy to install and easy to use

- *Centralized, automated data management* — IBM Tivoli Storage Manager simplifies the task of data protection by automating functions such as data backup and restore, managed data archiving and retrieval, disaster preparation planning and recovery, and hierarchical storage management.
- *Affordable, easy-to-manage servers* — IBM @server™ xSeries® and IBM @server BladeCenter® systems not only deliver exceptional availability, simplified manageability and outstanding performance, but have also been specifically tested to support Tivoli storage software.

Take advantage of this major breakthrough in data protection

Until now, the relatively few companies that did systematically back up their

laptop and desktop data could only do it on a periodic basis, usually every 24 hours. This method did more than leave end users' more recent and valuable work unprotected. It also created complex issues such as managing backup windows, protecting open files and databases, and handling the heavy impact of backup operations on production systems.

In contrast, Tivoli Continuous Data Protection for Files continuously and automatically safeguards all changes to important data — with no involvement from IT administrators. Furthermore, it does all this effortlessly and transparently — even, in some cases, eliminating the backup window.

Manage data centrally and automatically

As Tivoli Continuous Data Protection for Files collects backup files from laptops and desktops, they flow directly into Tivoli Storage Manager — so there are no potentially complicating interim steps through other types of software and hardware. With its powerful centralized management capabilities, Tivoli Storage Manager helps you protect data from hardware failures, errors and unforeseen disasters. It stores backup and archive copies on offline and offsite storage in a tiered storage environment that enables you to match the cost of storage to the business value of data.

To help reduce storage administration costs, the software offers intelligent data-move-and-store techniques and automates the implementation of your corporate retention and storage policies. At the same time, Tivoli Storage Manager backs up applications and other types of data daily. The result is a full backup and recovery solution — one that helps not only protect confidential and proprietary information, but also helps maximize the availability of key business data and applications.

Get affordable servers with mainframe-class capabilities

Whether you're protecting data in a small or medium-sized organization or a large corporation, you can still afford mainframe-class capabilities to support your solution thanks to IBM's family of xSeries servers and BladeCenter systems. These servers are based on IBM Enterprise X-Architecture™ and IBM Xtended Design Architecture™ technology, which provide a blueprint for bringing the power of advanced mainframe technologies to Intel® processor-based servers. As a result, you get mainframe-class availability, scalability and systems management in a cost-effective, industry-standard server designed to work within the Microsoft® Windows® environment of most desktops and laptops.

These IBM servers also feature comprehensive proactive and predictive systems management tools — a combination of hardware instrumentation and advanced software — to deliver automatic, self-managing capabilities that can help slash the cost of downtime for the server running your data protection solution. By selecting from this large family of servers, you get a server that is sized and powered to meet the exact needs of your organization — and do so cost efficiently.

Furthermore, you can take advantage of BladeCenter systems that can integrate servers, storage and networking to help simplify IT management — helping minimize complexity and costs through a flexible and highly scalable design.

Help simplify management with one-stop service

By choosing this integrated data protection solution from IBM, you eliminate the complexity of dealing with two or three different vendors. Rather than pointing fingers if an issue does arise, IBM teams work transparently behind the scenes to solve it. Even more important, IBM has solved most potential configuration and compatibility issues by thoroughly pretesting Tivoli storage management software on xSeries servers.

For more information

To learn more about how the highly integrated and effective IBM solution can enable you to protect important corporate data, contact your IBM representative or IBM Business Partner, or visit ibm.com/tivoli



© Copyright IBM Corporation 2005

IBM Corporation
Software Group
Route 100
Somers, NY 10589
U.S.A.

Produced in the United States of America
12-05

All Rights Reserved

BladeCenter, Enterprise X-Architecture, @server, IBM, the IBM logo, Tivoli, xSeries and Xtended Design Architecture are trademarks of International Business Machines Corporation in the United States, other countries or both.

Intel and the Intel Inside logo are trademarks or registered trademarks of Intel Corporation or its subsidiaries in the United States and other countries.

Microsoft and Windows are trademarks of Microsoft Corporation in the United States, other countries or both.

Other company, product and service names may be trademarks or service marks of others.